

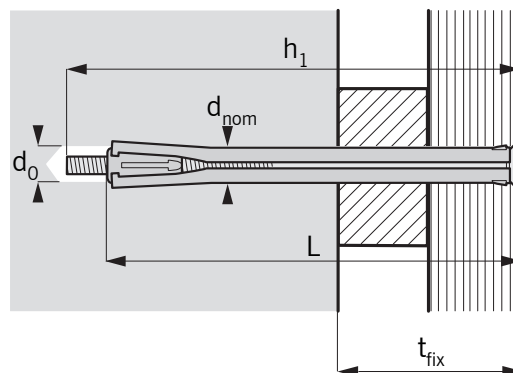

METAL FRAME FIXING

Installation:

For fast and easy fixing of door and window frames etc. in solid brick and concrete

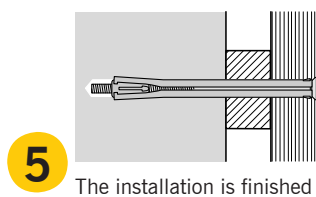
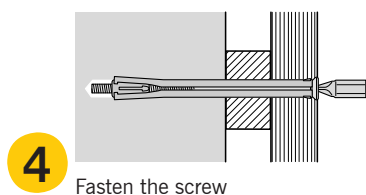
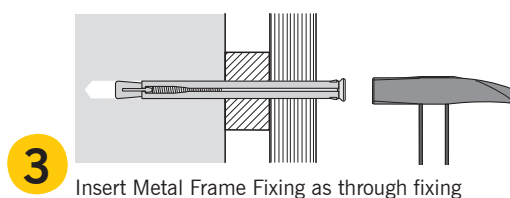
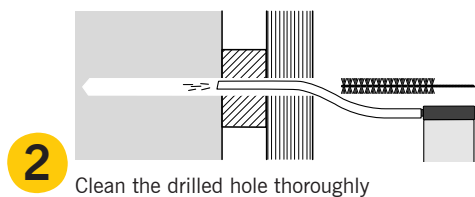
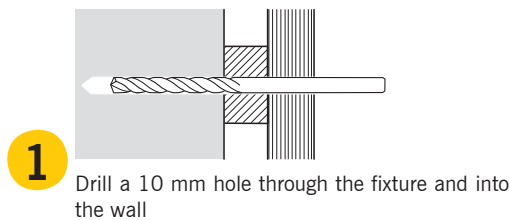

Type	Dimensions			Fixing		Load Capacities
	d_{nom}	L	t_{fix}	d_o	h_1	N_{Rd}
Expandet Metal Frame Fixing	Outside diameter of anchor mm	Anchor length mm	Thickness of fixture (Max.) mm	Drill hole diameter mm	Depth of drilled hole (Min.) mm	Design resistance tension kN*
10 x 75	10	75	30	10	100	0,80
10 x 90	10	90	50	10	115	0,80
10 x 110	10	110	70	10	135	0,80
10 x 130	10	130	90	10	155	0,80
10 x 150	10	150	110	10	175	0,80

* Design resistance for tension is valid for a single anchor in concrete C20/25

Safety factor is included (≥ 3). 1 kN \approx 100 kg.

Important: See Expandet's "Principles for fastening" for general information on fastening as well as information on limited liability. (Can be downloaded at www.expandet.com)

Advantages:

Through fixing.

Accessories:

Self-adhesive FastCap coversaps.

Materials:

Expandet Metal Frame Fixing consists of shield produced in alu-zinc and screw in zinc plated steel min. 5 μ m, poz. 3



EXPANDET SCREW ANCHORS A/S
Svendebuen 2-6
P.O. Box 59
DK-3230 Græsted
Denmark

Telephone: +45 70 22 79 79
Telefax: +45 70 22 79 89

Version 06.012

www.expandet.com
expandet@expandet.dk

Graphic: Vedkom /Expandet
©Expandet Screw Anchors A/S, 2006
All rights reserved