

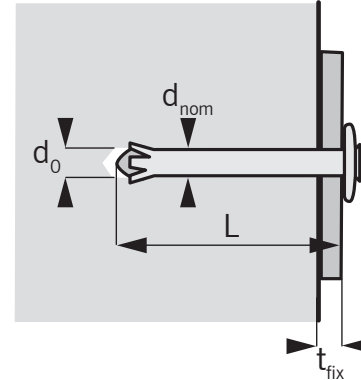

# ALUM-HAMMER RIVET

## Installation:

For fixing of cladding, sheet steel profiles and wall covering applications etc. in solid brick and concrete

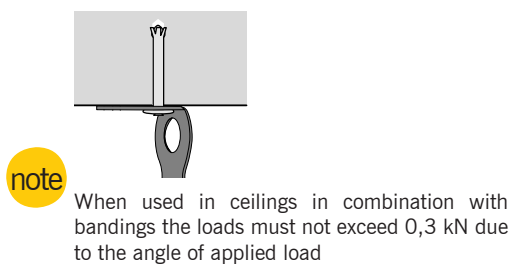
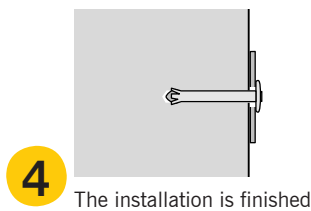
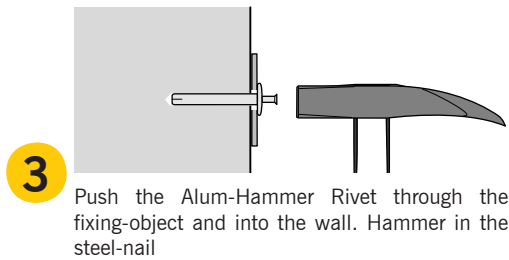
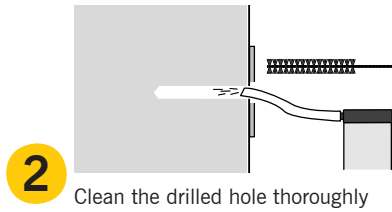
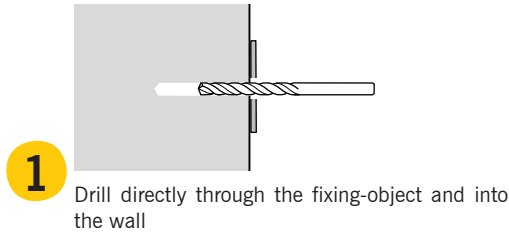

Type	Dimensions				Load Capacities			
	$d_{nom}$	L	$d_0$	$t_{fix}$	$N_{rec}$	$V_{rec}$	$N_{rec}$	$V_{rec}$
Expandet Alum-Hammer Rivet	Outside diameter of anchor mm	Anchor length mm	Drill hole diameter mm	Thickness of fixture (Max.) mm	Concrete 25 N/mm <sup>2</sup> Recommended tension load kN* Recommended shear load kN*		Solid brick Recommended tension load kN <sup>◇</sup> Recommended shear load kN <sup>◇</sup>	
4,8 x 16	4,8	16	5	1	0,35	0,35	0,35	0,35
4,8 x 20	4,8	20	5	5	0,35	0,35	0,35	0,35
4,8 x 26	4,8	26	5	11	0,35	0,35	0,35	0,35
4,8 x 30	4,8	30	5	15	0,35	0,35	0,35	0,35
4,8 x 35	4,8	35	5	20	0,35	0,35	0,35	0,35
4,8 x 40	4,8	40	5	25	0,35	0,35	0,35	0,35
4,8 x 50	4,8	50	5	35	0,35	0,35	0,35	0,35
6,4 x 40	6,4	40	6,5	25	0,40	0,40	0,40	0,40
6,4 x 50	6,4	50	6,5	35	0,40	0,40	0,40	0,40

♦ Recommended load capacity is maximum in concrete C20/25.  
 ◇ Recommended load capacity is maximum in solid brick with a compressive strength of minimum 15N/mm<sup>2</sup>.  
 Safety factor is included ( $\geq 3$ ). 1 kN  $\approx$  100 kg.  
**Important:** See Expandet's "Principles for fastening" for general information on fastening as well as information on limited liability. (Can be downloaded at [www.expandet.com](http://www.expandet.com))

## Materials:

The Alum-Hammer Rivet is made of zinc alloy aluminium with Inox A2 steel-nail.

Head diameter: 15 mm

## Advantages:

- Fast and easy through fixing.
- Corrosion resistant: Very suitable for outdoor use.
- Recommended for zinc- and alum-claddings.
- Small drill-depth and drill-diameter.
- Fire resistant fixing.



EXPANDET SCREW ANCHORS A/S  
 Svendebuen 2-6  
 P.O. Box 59  
 DK-3230 Græsted  
 Denmark

Telephone: +45 70 22 79 79  
 Telefax: +45 70 22 79 89

Version 06.012

[www.expandet.com](http://www.expandet.com)  
[expandet@expandet.dk](mailto:expandet@expandet.dk)

Graphic: Vedkom /Expandet  
 ©Expandet Screw Anchors A/S, 2006  
 All rights reserved