

METAL ANCHOR

Installation:

For fixing
in aerated concrete, breeze
and porous materials

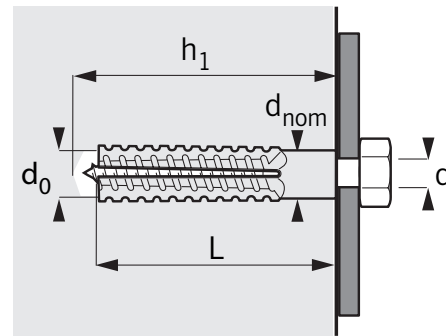
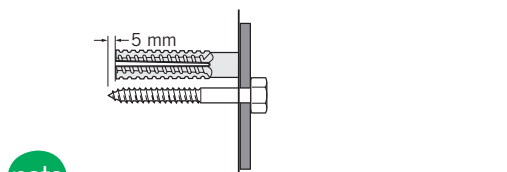
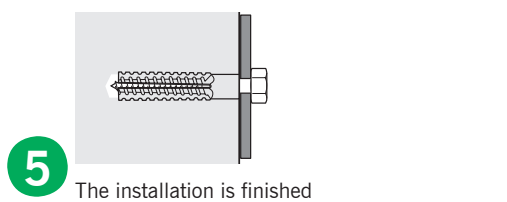
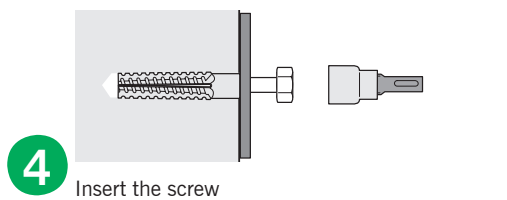
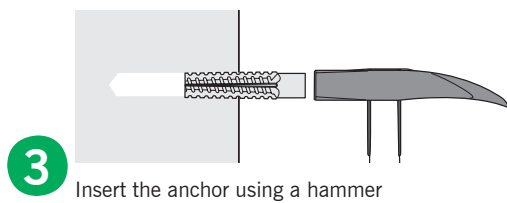
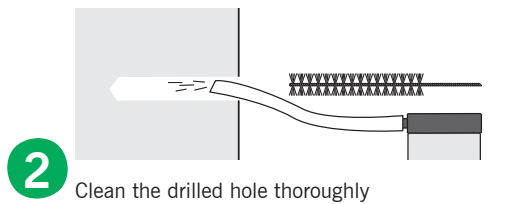
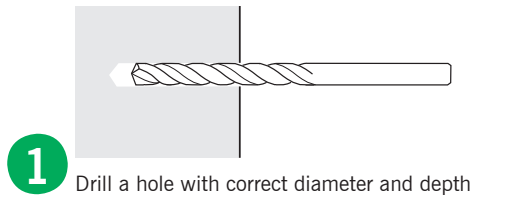

Type	Dimensions			Fixing		Load Capacities
	d_{nom}	L	d	d_0	h_1	F_{rec}
Expandet Metal Anchor	Outside diameter of anchor mm	Anchor length mm	Screw diameter mm	Drill hole diameter mm	Depth of drilled hole (Min.) mm	Recommended load kN*
6x32	6	32	4-6	4	40	0,40
8x38	8	38	6-8	6	45	0,60
8x60	8	60	6-8	6	70	0,75
10x60	10	60	8-10	8	70	0,88

* Recommended loads are maximum for a single anchor in aerated concrete PP4 independent of load direction together with largest recommended screw and without influence of edge and / or spacing.
Edge distance ≥ 100 mm.
Safety factor is included (≥ 3). 1 kN \approx 100 kg.
Important: See Expandet's "Principles for fastening" for general information on fastening as well as information on limited liability. (Can be downloaded at www.expandet.com)

Advantages:

- High pull-out value in porous material.
- Suitable for fixing in ceilings.
- Fire resistant.

Materials:

Expandet Metal Anchor is made of steel.
Zinc plated min. 5 μ m.



EXPANDET SCREW ANCHORS A/S
Svendebuen 2-6
P.O. Box 59
DK-3230 Græsted
Denmark

Telephone: +45 70 22 79 79
Telefax: +45 70 22 79 89

Version 06.012

www.expandet.com
expandet@expandet.dk

Graphic: Vedkom /Expandet
©Expandet Screw Anchors A/S, 2006
All rights reserved